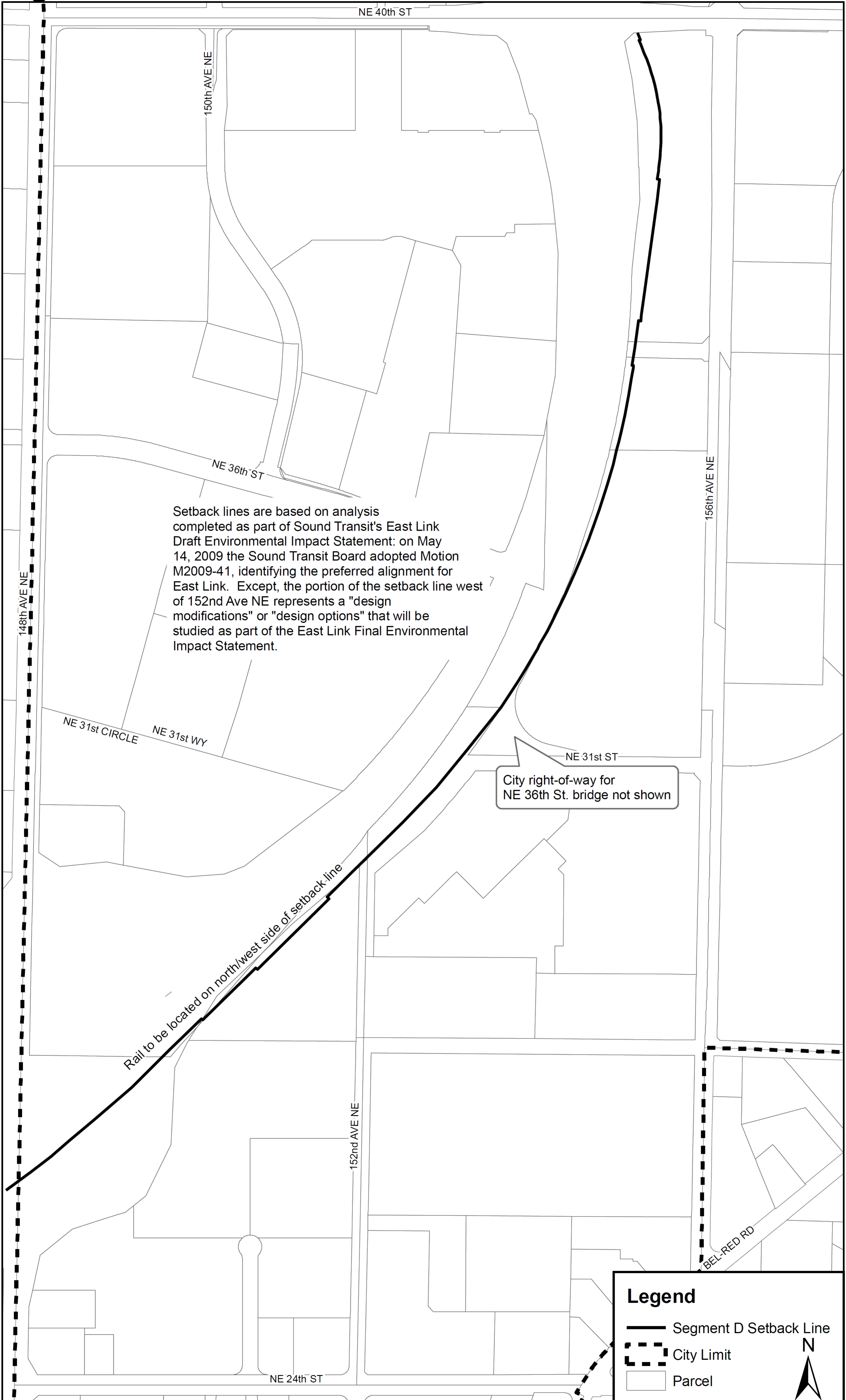

Figure 1



Setback lines are based on analysis completed as part of Sound Transit's East Link Draft Environmental Impact Statement: on May 14, 2009 the Sound Transit Board adopted Motion M2009-41, identifying the preferred alignment for East Link. Except, the portion of the setback line west of 152nd Ave NE represents a "design modifications" or "design options" that will be studied as part of the East Link Final Environmental Impact Statement.

1" = 360'

0 360 720 1,440 Feet